

NOTES:(EXIST.SERVICES)

- 1.0 THE POSITION AND LEVEL OF ALL EXISTING SERVICES TO BE CONFIRMED WITH THE ENGINEER BEFORE ANY CONSTRUCTION WORKS CAN COMMENCE.
- 2.0 THE REFERENCE PEGS GIVEN, ARE TO BE USED EXCLUSIVELY FOR THIS CONSTRUCTION PROJECT.
- 3.0 THE CONTRACTOR MUST SECURE THE ABOVEMENTIONED REFERENCE PEGS AND TAKE THE NECESSARY STEPS TO PROTECT THEM FOR FUTURE USE.
- 4.0 NO TREES WILL BE DAMAGED OR REMOVED WITHOUT THE WRITTEN APPROVAL OF THE ENGINEER.
- 5.0 ALL EXISTING SERVICES TO BE PROTECTED AND TO BE RESTORED TO THE ORIGINAL CONDITION AS FOUND BY THE CONTRACTOR BEFORE THE CONSTRUCTION OF THE NEW PROPOSED CIVIL SERVICES.
- 6.0 ALL THE NECESSARY PRECAUTIONS MUST BE UNDERTAKEN TO REDUCE DUST AND NOISE POLLUTION.
- 7.0 ALL CONSTRUCTION WORKS TO BE SUFFICIENTLY MARKED AND SECURED TO INSURE PUBLIC PROTECTION AND SAFETY.
- 8.0 ALL WORKS TO BE DONE IN ACCORDANCE WITH SABS 1200.

SEWER NOTES:

- 1.0 FINAL MANHOLE COVER LEVELS:
1.1 IN ROAD RESERVE TO TIE IN WITH THE FINAL ROAD RESERVE FORMAL LEVELS AND CARRIAGES.
1.2 OUTSIDE ROAD RESERVE 200mm HIGHER THAN FINISHED GROUND LEVELS.
- 2.0 WHERE THE PROPOSED SEWER SYSTEM CROSSES OR CONNECTS TO EXISTING SERVICES ALL LEVELS AND CONNECTION POINTS MUST BE CONFIRMED WITH THE ENGINEER BEFORE WORK COMMENCES.
- 3.0 MANHOLE COVER OPENING (PIPES UP TO 160mmØ) TO BE CENTRAL OVER MAIN PIPE ON THE DOWNWARD STREAM SIDE.
- 4.0 REFER TO THE DETAIL DRAWING FOR ALL RELEVANT DETAILS.
- 5.0 SEWER CONNECTIONS TO BE END-CAPPED AND MARKED.
- 6.0 CONFIRM DEPTH AND POSITION OF ALL EXISTING SERVICES WITH THE ENGINEER BEFORE CONSTRUCTION COMMENCES.
- 7.0 APPROPRIATE AUTHORITY OFFICIALS TO BE PRESENT WITH THE CROSSING OF OR THE CONNECTION TO ANY EXISTING SERVICE.
- 8.0 CONNECT TO EXISTING MANHOLES AS INDICATED ON PLAN.

SEWER SPECIFICATIONS:

- 1.0 SEWER PIPES:
PIPES TO BE 160mm Ø UPVC CLASS 34 PIPES TO BE LAID ON CLASS C BEDDING.
- 2.0 MANHOLE COVER AND FRAMES HEAVY DUTY DUCTILE IRON WITH HINGE IN COMPLIANCE WITH EN 124 D400. SAMPLE TO BE PROVIDED FOR APPROVAL.
- 3.0 CALCARITE STEP-IRONS TO BE USED WHERE REQUIRED.
- 4.0 MANHOLES:
4.1 PRECAST CONCRETE RING MANHOLES AS PER DETAIL.
4.2 MANHOLES TO BE WATER TIGHT.

REVISION:

No.	DATE	DESCRIPTION

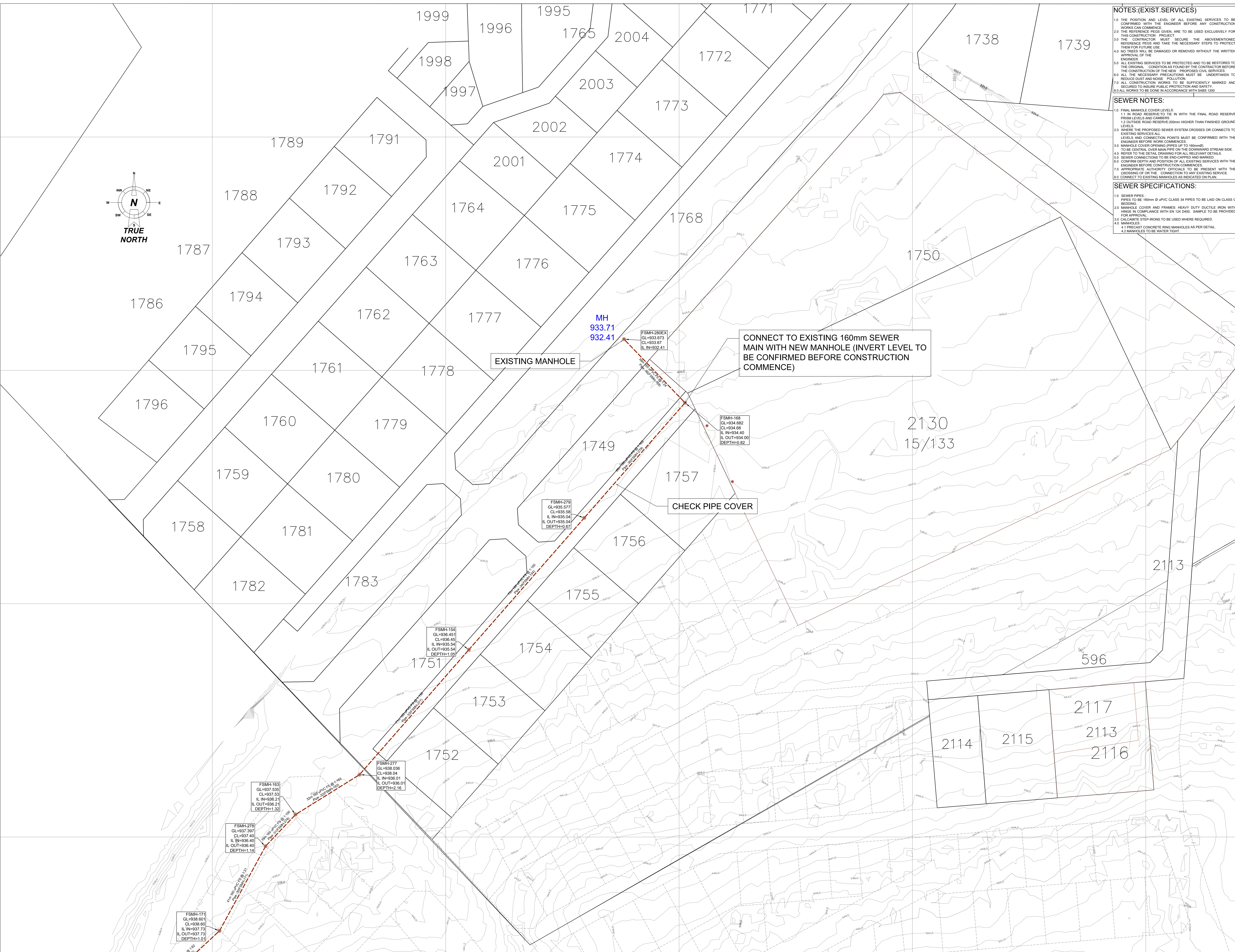
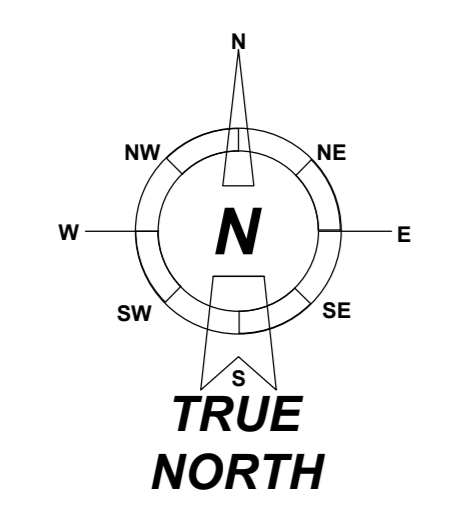

FOR TENDER

LEGEND:

	Foul Sewer Pipe Exist.
	Foul Sewer MH Exist.
	Foul Sewer Pipe.
	Foul Sewer Manhole.
	Foul Sewer Conn. Point.
	Water Pipe - Domestic.
	Water Valve.
	Sewer Exist. Septic Tanks.

PROJECT:
VAALHOEK, O'KIEP,
SEWER RETICULATION
NETWORK

DRAWING TITLE:
PROPOSED SEWER
LAYOUT

CLIENT:

NAMA KHOI
MUNICIPALITY
4 Namakwa Street
SPRINGSIDE, 6240

RAIBICON CONSULTING GROUP
Call: 021 718 2253 PO Box 767 SPRINGBOK, 6240
#Raibicon.com
Graeme McGill consulting
Call: 082 550 9168 PO Box 332 Private Bag X1 KLEINMOND, 7195
grame@mcgillconsulting.co.za

DRAWN/DESIGNED BY	APPROVED BY
C BENEKE	GA McGill, Pr Eng No. 780269
DATE	2024-10-10
SCALE	1:500 (A0)
DRAWING NO	MC444-C901
REVISION	1